

model no:

SG300D, SG300P, SG301D, SG301P, SG303D,
SG303P, SG304D, SG304P, SG306D, SG306P,
SG307D, SG307P, SG312D, SG312P, SG313D,
SG313P, SG315D, SG315P, SG316D, SG316P,
SG318D, SG318P, SG319D, SG319P,
SIGNATURE SERIES



WABASH VALLEY

6' & 8' BENCH WITH & WITH OUT BACK – EXPANDED METAL
& PERFORATED – PORTABLE, INGROUND & SURFACE MOUNT

© Wabash Valley Manufacturing, Inc.

customer service:

ASSEMBLERS: If you find any parts missing or damaged, or if you're having difficulty assembling your furniture/equipment, call us at:

* Before calling, have your product model number available.

1-800-253-8619 (Inside U.S.A.)

260-352-2102 (Outside U.S.A.)

Monday thru Friday,
8:00 AM – 4:30 PM Eastern Time
(EXCEPT HOLIDAYS)

Any correspondence concerning our product should be sent directly to our Customer Service Manager at:

Wabash Valley Manufacturing, Inc.
505 E. Main Street
P.O.Box 5
Silver Lake, IN 46982 U.S.A.
FAX: 260-352-2160

maintenance:

Regular inspection and maintenance of all parts, and fasteners is necessary. Tighten all bolts and nuts. Inspect Tops, Seats, Legs, Braces and Fasteners periodically for wear or vandalism. Replace broken or worn parts immediately or take equipment out of service until repairs are made. Use genuine Wabash Valley replacement parts.

To restore plastisol coating to its luster after prolonged use, wash/rinse/dry and use Armor-All ® or similar quality vinyl protectant.

KEEP THIS ASSEMBLY/SPECIFICATION SHEET FOR FUTURE REFERENCE.

specifications:

NOTE: We reserve the right to change specifications without notice.

Heat fused poly-vinyl coating, finished on inner-metal structure, to an approximate 3/16" thickness. Framework assemblies are finished with powder coating; electrostatically applied and oven cured according to powder manufacturer's specifications. Fasteners are stainless steel to resist corrosion.

BENCH FRAME:

Main supports are constructed of 2 3/8" od x 12 gage structural steel tubing. Braces are 1" od x 15 gage structural steel tubing. Mounting brackets on legs are 1/4" x 2" steel flat bar or 10 gage sheet steel. Base plates are 1/4" plate steel.

SEATS:

Seat and back uses 3/4" #9 expanded steel mesh and 12 gage sheet steel for the perforated. Framing consists of die formed 10 gage mitered angles 3/4" x 1 3/4". Center brace and mounting brackets are 1/4" x 1 1/2" steel flat bar.

GENERAL:

6' bench ground space requirements are; inground and surface mount with out back is 10 3/8" x 72 3/8", with back is 19 5/8" x 72 3/8", portable with out back is 18 1/8" x 72 3/8", with back is 23 3/16" x 72 3/8". Seats are 10 3/8" wide x 72 3/8" long, 19" to top of seat and 31 3/4" to top of bench. Corner radius is 3" to the outside.

8' Bench ground space requirements are; inground and surface mount with out back is 10 3/8" x 96 3/8", with back is 19 5/8" x 96 3/8", portable with out back is 18 1/8" x 96 3/8", with back is 23 3/16" x 96 3/8". Seats are 10 3/8" wide x 96 3/8" long, 19" to top of seat and 31 3/4" to top of bench. Corner radius is 3" to the outside.

parts identification:

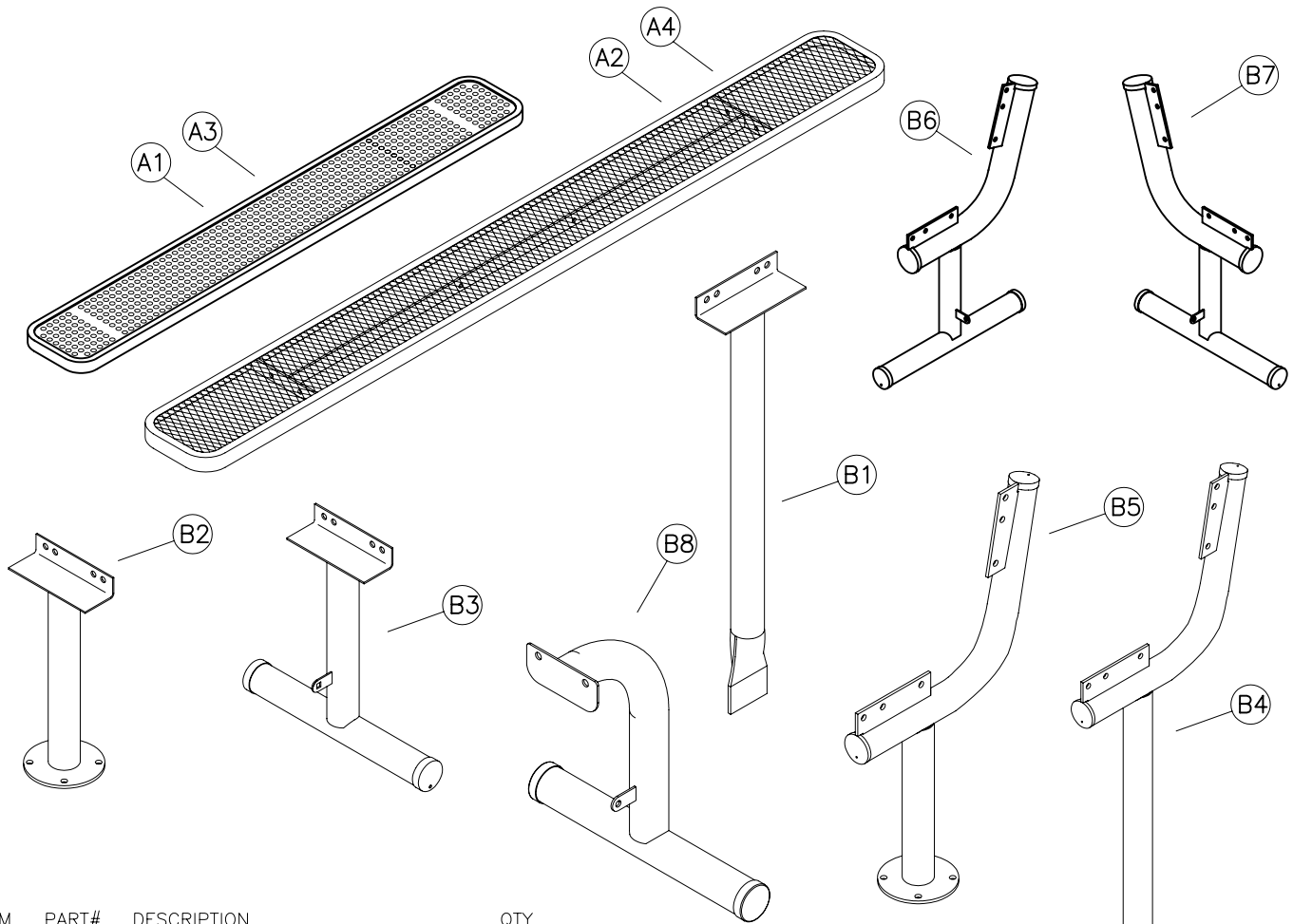

ITEM	PART#	DESCRIPTION	QTY
A1	7529R	6' EXPANDED METAL SEAT	1
A2	7527R	8' EXPANDED METAL SEAT	1
A3	7994	6' PERFORATED SEAT	1
A4	7992	8' PERFORATED SEAT	1
B1	7339	BENCH W/O BACK INGROUND LEG	2
B2	7340	BENCH W/O BACK SURFACE LEG	2
B3	7341	BENCH W/O BACK PORTABLE LEG	2
B4	7345	BENCH W/BACK INGROUND LEG	2
B5	7346	BENCH W/BACK SURFACE LEG	2
B6	7347	BENCH W/BACK PORTABLE RIGHT LEG	1
B7	7348	BENCH W/BACK PORTABLE LEFT LEG	1
B8	7072	8' RE/PLAYER PORTABLE LEG	2
C1	7388	BRACE	2
C2	7120	MOUNTING PLATE COVER (OPTIONAL)	2
C3	7073	8' RE/PLAYER BRACE	2

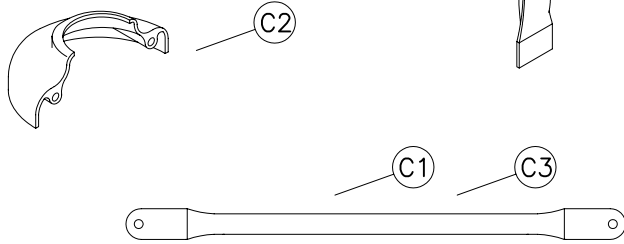

hardware identification:

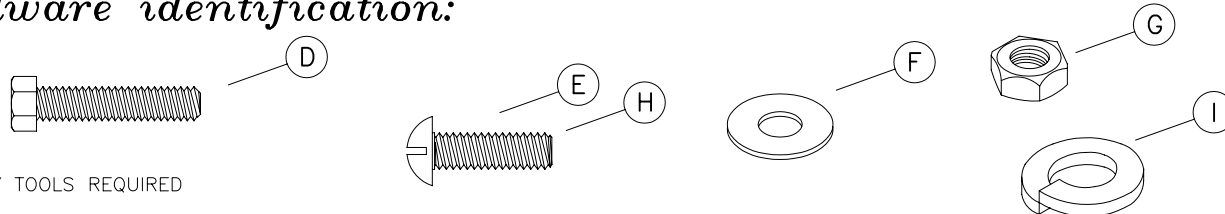

ASSEMBLY TOOLS REQUIRED

- 1 - REGULAR TIP SCREWDRIVER
- 2 - 1/2" WRENCHES
- 1 - 3' OR 6' LEVEL

ITEMS INCLUDED IN HARDWARE PACKAGE #:

ITEM	PART#	DESCRIPTION	21011 QTY	21012 QTY	21013 QTY	21014 QTY	21069 QTY	21076 QTY	21101 QTY
D	17011	5/16-18 x 1 1/2" HEX HEAD BOLT - SS	6	8	10	4	4	8	0
E	17088	5/16-18 x 1" TRUSS HEAD MACHINE SCREW - SS	2	0	2	0	0	0	0
F	17028	3/8" FLAT WASHER - SS	16	16	24	8	8	16	0
G	17032	5/16-18 HEX FINISH NUT - SS	8	8	12	4	4	8	0
H	17052	1/4-20 x 1" MACHINE SCREW - SS	0	0	0	0	0	0	2
I	17050	5/16" SPLIT LOCK WASHER - SS	8	8	12	4	4	8	0

assembly procedures: IMPORTANT: Assemblers should be reasonably skilled in the assembly of commercial grade/heavy duty fabricated steel equipment.

To ensure proper assembly, it is suggested that you take adequate time to locate and identify each part. To prevent scratching of the finished pieces, we recommend this unit to be assembled on a clean, flat, solid, surface with a drop cloth, allowing plenty of working room. Also please read the instructions and study the sketches very carefully. A little extra time spent before assembly will be well worth it in performing a complete, proper assembly. Please note that all parts have been pre-cut and pre-drilled.

During the assembly process leave all bolts and nuts "finger tight", until the entire unit is completely assembled. This allows room for movement to level or adjust all seats, tops, benches, framework and braces if necessary. After final adjustment and leveling, permanently tighten all nuts, bolts and fasteners.

7L

PORTABLE WITH BACK

STEP 1

Invert the (A-) seat upside down on an elevated surface. Place edge of seat flush with surface. Attach both (B6) and (B7) right and left legs to the outer most part of the seat's mounting brackets, with the tab on each leg facing each other toward the center of the seat, see FIG. 1. Use two, per leg, (D) and (G) using two (F) and one (I) per (D).

STEP 2

Attach one end of the (C1) brace to tab on leg. Use one (E), (G), (I) and two (F) per (E). Attach opposite end of brace to the center brace on the seat. Use one (D), (G), (I) and two (F) per (D). Repeat STEP 2 for other end.

STEP 3

Rotate bench to the upright position. Attach the second seat (A1) or (A2) to the outer most part of the bench's back mounting bracket, see FIG. 2. Use two, per each side, (D) and (G) using two (F) and one (I) per each (D).

FIG. 1

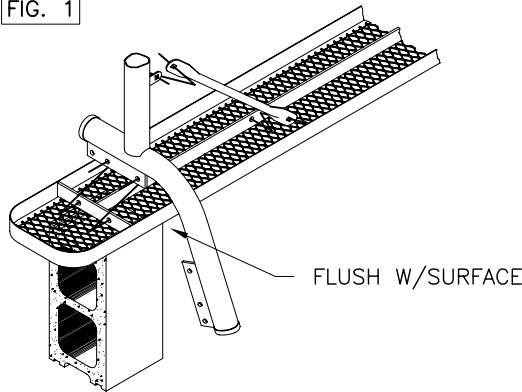
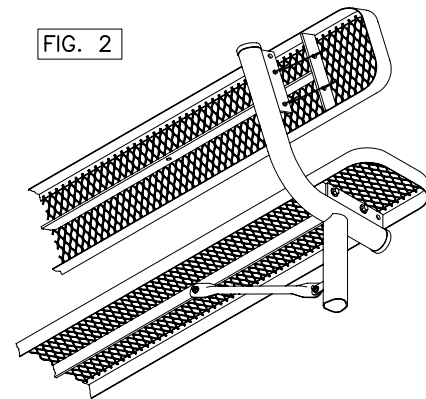

FIG. 2



PORTABLE WITH OUT BACK

STEP 1

Invert the (A-) seat upside down on a flat surface. Attach both (B3-6') or (B8-8' not shown) legs to the outer most part of the seat's mounting brackets, with the tab on each leg facing each other toward the center of the seat, see FIG. 3. Use two, per leg, (D) and (G) using two (F) and one (I) per (D).

STEP 2

Attach one end of the (C1-6') or (C3-8') brace to tab on leg. Use one (E), (G), (I) and two (F) per (E). Attach the opposite end of brace to the center brace on the seat. Use one (D), (G), (I) and two (F) per (D). Repeat STEP 2 for the other end.

STEP 3

Rotate bench to the upright position.

FIG. 3

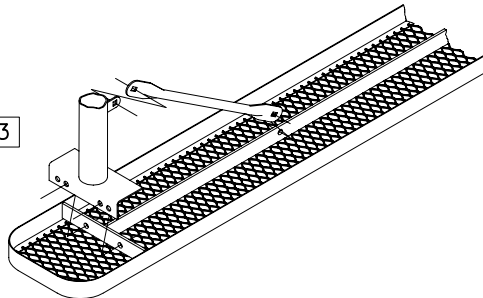

installation: WARNING: The proper installation for Wabash Valley products may depend upon many factors unique to the site, location, or use of a particular product. Consult with your contractor or other professional to determine your specific installation requirements.

product dimensions:

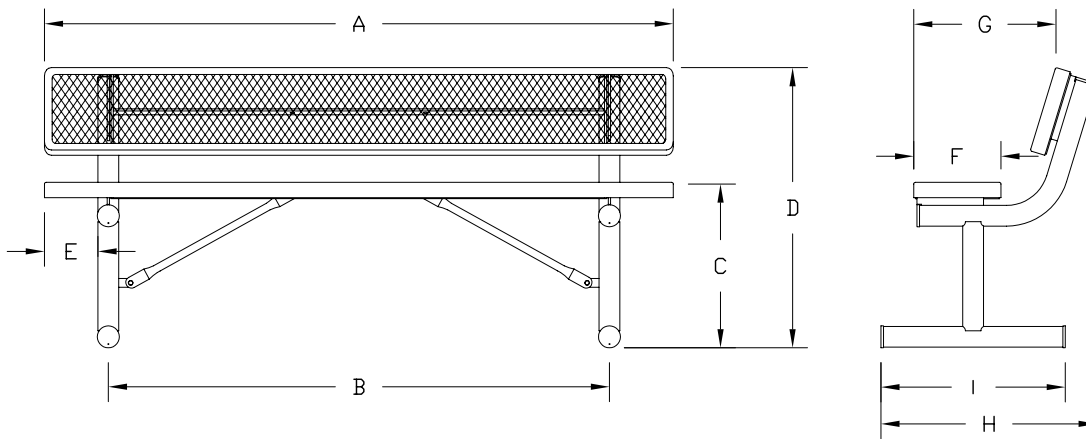

PORTABLE	A	B	C	D	E	F	G	H	I
6' W/O BACK	72 3/8"	54 1/2"	19"	-	7 3/4"	10 3/8"	-	-	18 1/8"
6' W/ BACK	72 3/8"	57 3/8"	19"	31 3/4"	6 5/16"	10 3/8"	15"	23 3/16"	18 1/8"
8' W/O BACK	96 3/8"	62 1/2"	19"	-	15 3/4"	10 3/8"	-	-	18 1/8"
8' W/ BACK	96 3/8"	65 3/8"	19"	31 3/4"	14 5/16"	10 3/8"	15"	23 3/16"	18 1/8"

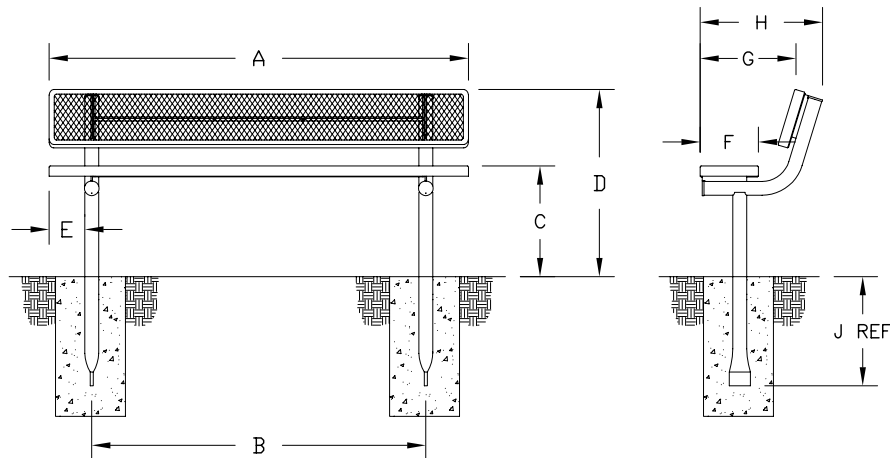

INGROUND	A	B	C	D	E	F	G	H	J
6' W/O BACK	72 3/8"	54 1/2"	19"	-	7 3/4"	10 3/8"	-	-	18 1/8"
6' W/ BACK	72 3/8"	57 3/8"	19"	31 3/4"	6 5/16"	10 3/8"	15"	19 5/8"	20 1/8"
8' W/O BACK	96 3/8"	62 1/2"	19"	-	15 3/4"	10 3/8"	-	-	18 1/8"
8' W/ BACK	96 3/8"	65 3/8"	19"	31 3/4"	14 5/16"	10 3/8"	15"	19 5/8"	20 1/8"

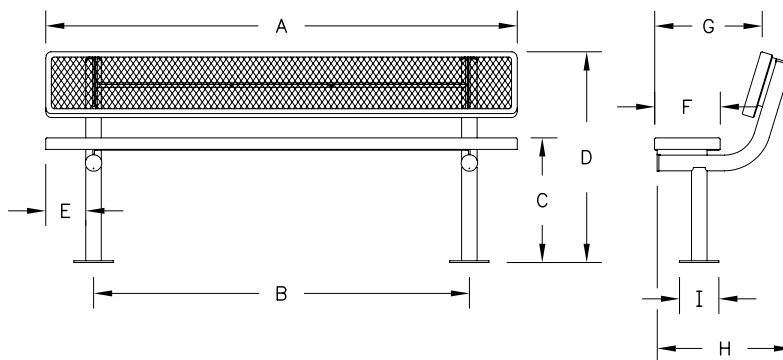

SURFACE	A	B	C	D	E	F	G	H	I
6' W/O BACK	72 3/8"	54 1/2"	19"	-	7 3/4"	10 3/8"	-	-	6"
6' W/ BACK	72 3/8"	57 3/8"	19"	31 3/4"	6 5/16"	10 3/8"	15"	19 5/8"	6"
8' W/O BACK	96 3/8"	62 1/2"	19"	-	15 3/4"	10 3/8"	-	-	6"
8' W/ BACK	96 3/8"	65 3/8"	19"	31 3/4"	14 5/16"	10 3/8"	15"	19 5/8"	6"

assembly procedures, cont'd:

SURFACE MOUNT WITH BACK

STEP 1

Invert the (A-) seat upside down on an elevated surface. Place edge of seat flush with surface. Attach both (B5) legs to the outer most part of the seat's mounting brackets, see FIG. 4. Use two, per leg, (D) and (G) using two (F) and one (I) per (D).

STEP 2

Reinvert bench to its top side up position. Attach the second seat (A-) to the outer most part of the bench's back mounting bracket, see FIG. 5. Use two, per each side, (D) and (G) using two (F) and one (I) per each (D).

STEP 3

Prepare and place the foundations securement hardware in its chosen location. A detailed description of where the hole locations should be placed is shown on page 4.

When the foundations securement hardware has been installed, place the unit in its new location and secure to the foundation.

If mounting plate covers (C2) are used place halves around legs and secure with 2 (H) screws, see FIG. 12. Draw to a snug fit being careful not to over tighten.

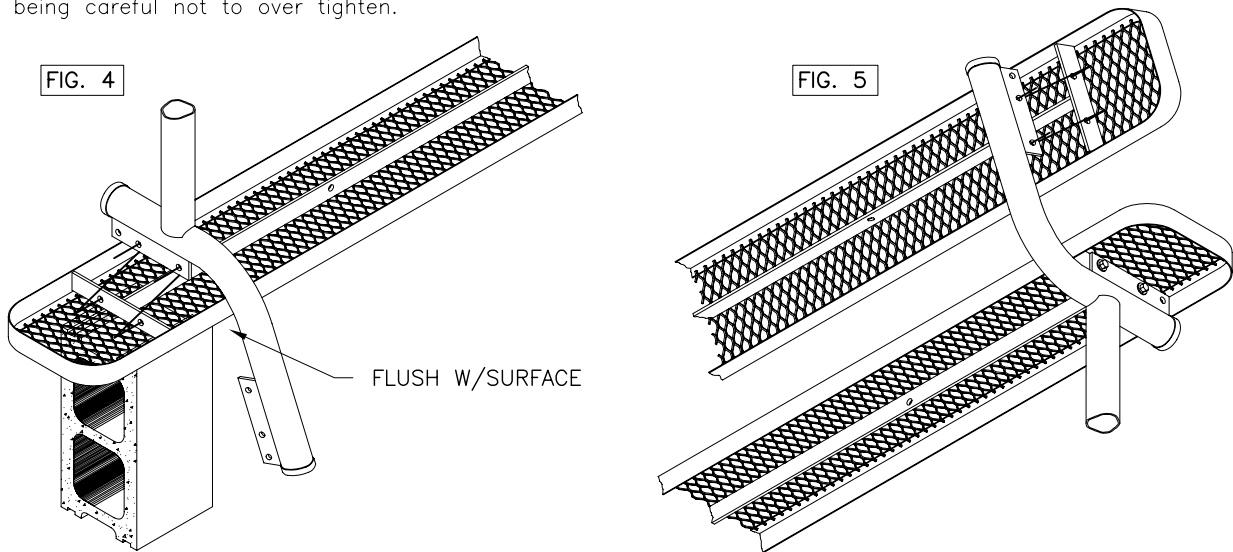

SURFACE MOUNT WITH OUT BACK

STEP 1

Invert the (A-) seat upside down on a flat surface. Attach both (B2) legs to the outer most part of the seat's brackets, see FIG. 6. Use two, per leg, (D) and (G) using two (F) and one (I) per (D).

STEP 2

Reinvert bench to its top side up position.

STEP 3

Prepare and place the foundations securement hardware in its chosen location. A detailed description of where the hole locations should be placed is shown on page 4.

When the foundations securement hardware has been installed, place the unit in its new location and secure to the foundation.

If mounting plate covers (C2) are used place halves around legs and secure with 2 (H) screws, see FIG. 12. Draw to a snug fit being careful not to over tighten.

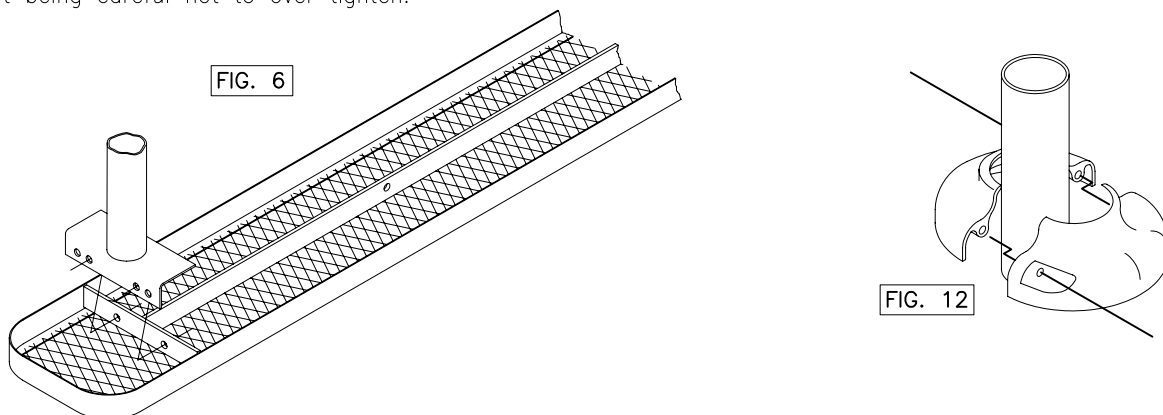

assembly procedures, cont'd:

INGROUND WITH BACK

STEP 1
Invert the (A-) seat upside down on an elevated surface. Place edge of seat flush with surface. Attach both (B4) legs to the outer-most part of the seat's mounting brackets, see FIG. 7. Use two, per leg, (D) and (G) using two (F) and one (I) per (D).

STEP 2
Prepare two foundation holes as shown in FIG. 8. The distance of holes, center to center, are shown in a diagram on page 4. Reinvert the bench to its' top side up position and place the legs in the footing holes, see FIG. 8.

Before pouring concrete, make sure the bench is level horizontally as well as vertically and holds 19" to the top of the bench. Pour concrete to form the footings and let cure for 48 hours.

STEP 3
Attach the second bench (A1) or (A2) to the outer most part of the bench's back mounting bracket, see FIG. 9. Use two, per each side, (D) and (G) using two (F) and one (I) per each (D).

If mounting plate covers (C2) are used place halves around legs and secure with 2 (H) screws, see FIG. 12. Draw to a snug fit being careful not to over tighten.

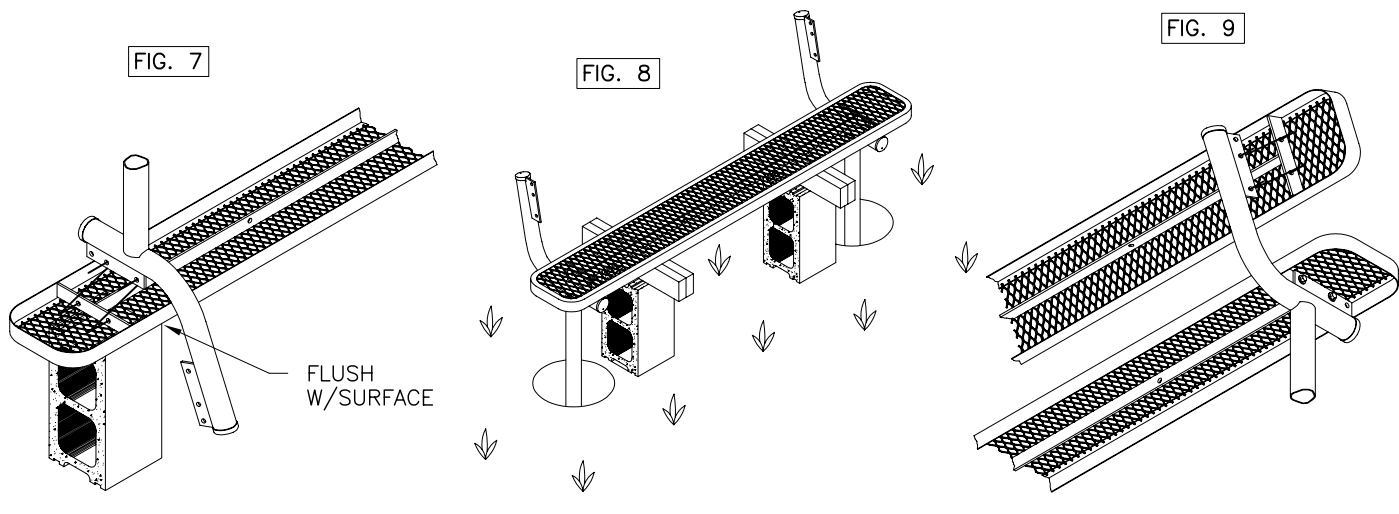

INGROUND WITH OUT BACK

STEP 1
Invert the (A-) seat upside down on a flat surface. Attach both (B1) legs to the outer most part of the seat's mounting brackets, see FIG. 10. Use two, per leg, (D) and (G) using two (F) and one (I) per (D).

STEP 2
Prepare two foundation holes as shown in FIG. 11. The distance of the holes, center to center, are shown in a diagram on page 4. Reinvert the bench to its' top side up position and place the legs in the footing holes. Block the bench as shown in FIG. 11.

Before pouring concrete, make sure the bench is level horizontally as well as vertically and holds 19" to the top of the bench. Pour concrete to form the footings and let cure for 48 hours.

If mounting plate covers (C2) are used place halves around legs and secure with 2 (H) screws, see FIG. 12. Draw to a snug fit being careful not to over tighten.

